

# TOPOGRAPHIC SURVEY OF EXISTING JET FUEL LINE PEARL HARBOR, HI

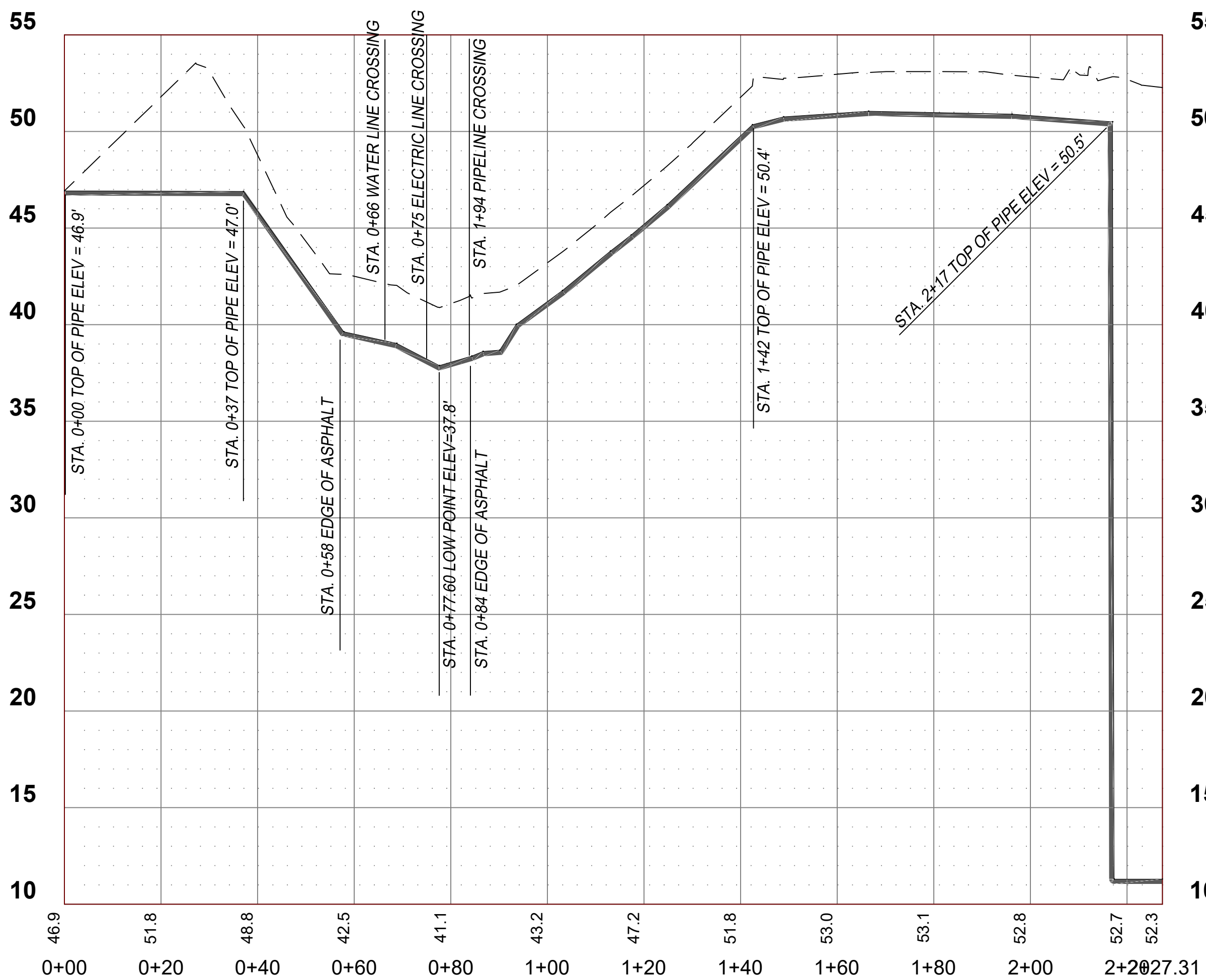

0 5 10  
1" = 5 US Feet (V)



LEGEND	
	TREE
	SIGN
	SEWER CLEAN OUT
	GAS METER
	MAIL BOX
	WATER METER
	TELEPHONE PEDISTAL
	POWER POLE
	HYDRANT
	SEWER MANHOLE
	ELECTRICAL MANHOLE
	FINISH FLOOR ELEV.
	DITCH
	OVERHEAD ELEC.
	WATER LINE
	FENCE LINE
	GAS LINE
	FIBER-OPTIC LINE
	FORCE MAIN
	CONCRETE
	GRAVEL
	ASPHALT DRIVE

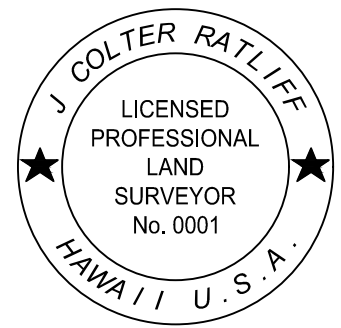

J. Colter Ratliff, P.S.  
Field Surveyed October 28, 2025  
Revised November 7, 2025 to show  
edge of asphalt in profile view.



0 20 40  
1" = 20 US Feet (H)

## NOTES:

- COPIES OF THIS SURVEY WITHOUT AN ORIGINAL SIGNATURE BLUE INK ARE NOT VALID. ANY ALTERATION OF THIS SURVEY, IN WHOLE OR PART, WITHOUT PRIOR WRITTEN PERMISSION OF HAWAII SURVEYING IS PROHIBITED.
- THIS SURVEY IS REFERENCED TO THE HAWAII STATE PLANE ZONE 3 (5103) WITH NAD (83) DATUM. SCALE FACTOR AT CONTROL POINT 100: 0.999990511. CONVERGENCE ANGLE AT CONTROL POINT 100: 00° 01' 21.284". ALL DISTANCES AND COORDINATES SHOWN HEREON ARE IN U.S. SURVEY FEET. (3.28083333 PER METER).
- ALL UNDERGROUND UTILITIES SHOWN HEREON WERE MARKED BY GPRS, INC. AND LOCATION SURVEYED BY HAWAII SURVEYING.
- ELEVATIONS OF PIPE SHOWN IN THE PROFILE VIEW ARE BASED ON UTILITY LOCATE DEPTHS PROVIDED BY UTILITY LOCATE CONTRACTORS. NONE OF THE LOCATIONS SHOWN HAVE BEEN EXPOSED NOR HAD A DIRECT ELEVATION SHOT TAKEN ON THEM FOR AN ACCURATE ELEVATION TO BE PROVIDED.



1888 Kalia Avenue - Suite C312  
Honolulu, Hawaii 96815  
PHONE: 808-761-0203  
EMAIL: colt@hawaiisurveying.com

PROJECT NUMBER : 1007.02 R1